

# The Small Cruise Ship Collection

www.small-cruise-ships.com

small-cruise-ships.com

info@small-cruise-ships.com

## ULTIMATE QUEST

This is the ultimate wilderness cruise along the whole Kimberley coast. Our 14 day Kimberley cruise between Broome and Wyndham really does have it all! Witness amazing Kimberley icons such as the King George Falls, Berkley River, Montgomery Reef and the Horizontal Waterfalls - to name just a few. Enjoy refreshing swims in fresh waterholes, explore historical Aboriginal art sites, view majestic gorges and fish for the elusive Barramundi plus many other fish. This cruise operates just after the wet season when the waterfalls are spectacular!

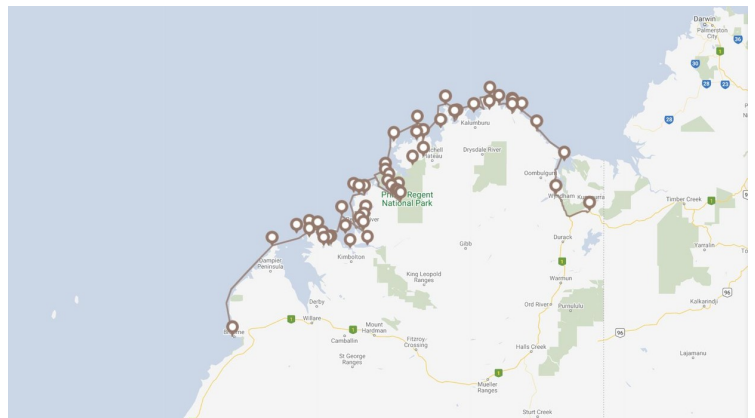

### ITINERARY

#### DAY 1: BROOME - CAPE LEVEQUE

Your Ultimate Quest begins when a courtesy vehicle picks you up from your accommodation at approximately 4.30pm and transfers you to the Kimberley Quest II, where you will be welcomed on board by your captain and crew. Enjoy a relaxing drink as you watch the sun dip below the horizon, while cruising past the famous Cable Beach.

#### DAY 2: BUCCANEER ARCHIPELAGO, DUGONG BAY, TALBOT BAY

This morning will find us crossing the vast King Sound, cruising through the thousand islands of the Buccaneer Archipelago; this is your first taste of the Kimberley. Cool off with a refreshing swim in Dugong Bay, followed by a scenic tender excursion. Around the corner lies Talbot Bay, home to one of the icons of the Kimberley coast, the spectacular Horizontal Waterfalls. Take a tender and head in for an up-close and exhilarating ride through this natural phenomenon. In the afternoon take a scenic

The Small Cruise Ship Collection

www.small-cruise-ships.com

01432 507 280 (within UK)

info@small-cruise-ships.com | small-cruise-ships.com



## The Small Cruise Ship Collection

[www.small-cruise-ships.com](http://www.small-cruise-ships.com)

[small-cruise-ships.com](http://small-cruise-ships.com)

[info@small-cruise-ships.com](mailto:info@small-cruise-ships.com)

excursion up the back of Cyclone Creek to marvel at the amazing rock formations.

#### DAY 3: COLLIER BAY, MONTGOMERY REEF, RED CONE CREEK

Early morning we take you barramundi fishing in Collier Bay and then cruise to the amazing Montgomery Reef, which covers more than 300km<sup>2</sup>, making it Australia's largest inshore reef. Watch as the tide falls right before your eyes, creating a waterfall effect as the reef rises out of the water. Then take a ride in the tenders to observe many marine species, including turtles and sea birds. In the afternoon we cruise to Red Cone Hill for a refreshing swim at Ruby Falls, or try your luck at mud-crabbing.

#### DAY 4: DOUBTFUL BAY, SALE RIVER, RAFT POINT

This morning we fish the inlets of Doubtful Bay for the elusive barramundi and threadfin salmon. We then explore the Sale River and take an excursion upstream for a dip in the spring-fed rainforest pools, on the journey home, view ancient rock art from the tenders. We then head to Steep Island and anchor below Raft Point, as we prepare to walk to the caves perched on the hill, here is some of the finest well preserved Wandjina art in the Kimberley. From the top we have an amazing view of the Kimberley Coast as the sun begins to set, capturing this unique landscape at its best.

#### DAY 5: LANGII, KURI BAY, CAMDEN HARBOUR

Visit the mysterious cove at Langii and witness the 'Petrified Warriors'. These remarkable sandstone pillars represent the warriors killed in a Dreamtime battle. Enjoy a swim in the pristine ocean. We then cruise between Augustus Island and the mainland, passing the remote pearling settlement of Kuri Bay. At nearby Camden Harbour, we visit forlorn settler's graves on Sheep Island and soak up the history of the early European

settlement. Take one of the tenders for a spot of exploration, have a go at fishing or collecting rock oysters. Alternatively relax on the sundeck to take in the beautiful scenery.

#### DAY 6: PRINCE REGENT RIVER, KING CASCADE, CATHEDRAL FALLS

Early morning we cruise through St George Basin, a stunning inland sea. Leaving the vista of mighty Mt Trafalgar and Mt Waterloo, we cruise up the Prince Regent River, marvel at the pristine waterway that cuts through sandstone cliffs and gorges. Arriving at the King Cascade waterfalls, which is spring fed, marvel at the rush of water cascading in breathtaking tiers, surrounded by lush ferns and a myriad of wildlife. Climb above the falls for an unforgettable swim in a massive crystal clear pool. Be rewarded with a breathtaking view over the magnificent Prince Regent River in the distance - wilderness adventuring at its best! Late afternoon join our guides for an excursion to Cathedral Falls, while spotting crocodiles and flying foxes. Alternatively fish the Prince Regent River which is renowned for big barra and threadfin salmon.

#### DAY 7: CAREENING BAY, BIGGE ISLAND

Visit Careening Bay, site of an ancient carved boab tree first visited in 1820 by Phillip Parker King whilst on a hydro-graphic survey off the Australian coastline. Next we cruise north to Bigge Island, one of the largest sandstone islands and home to amazing Bradshaw art and Wandjina art with a maritime theme. As we continue our journey, witness the rugged terrain and ancient weathered rocks from the vessel while cruising towards the Mitchell River.

#### DAY 8: MITCHELL RIVER, SURVEYORS CREEK

We are now entering the incredible assortment of islands that form the Bonaparte Archipelago. Cruise to the Mitchell River,

The Small Cruise Ship Collection  
[www.small-cruise-ships.com](http://www.small-cruise-ships.com)

01432 507 280 (within UK)

[info@small-cruise-ships.com](mailto:info@small-cruise-ships.com) | [small-cruise-ships.com](http://small-cruise-ships.com)



## The Small Cruise Ship Collection

[www.small-cruise-ships.com](http://www.small-cruise-ships.com)

[small-cruise-ships.com](http://small-cruise-ships.com)

[info@small-cruise-ships.com](mailto:info@small-cruise-ships.com)

source of the magnificent Mitchell Falls where you can charter a helicopter and take an exhilarating ride over the Mitchell Falls. Drop a lure in later and perfect your fishing skills in these rich waters or go crocodile spotting. Late afternoon enjoy a swim in the cool tranquil waters of Surveyors creek.

#### DAY 9: VANSITTART BAY, WWII DC3 CRASH SITE

Today we explore various coves within Vansittart Bay, visiting sites rich in the fascinating Bradshaw or Gwion Gwion art. Named after Joseph Bradshaw, the first European to record these amazing paintings in 1891. Some Bradshaw art has been dated at over 17,000 years old, which is unique to the Kimberley. There is also the opportunity to visit the crash site of a DC3 aircraft, located on the eastern side of Vansittart Bay.

#### DAY 10: DRYSDALE RIVER

Today we encounter one of the longest rivers in the Kimberley (432km), the Drysdale. Spend the day exploring the spectacular palm-studded landscape and the rapids of the Drysdale area. Join our guides on a scenic tender excursion to witness crocodiles, flying foxes and many species of bird life, which thrive in these delta islands. Then enjoy a swim in secluded rock pools. Late afternoon walk on a deserted beach or try to catch a barramundi, with many great "snags" to fish around.

#### DAY 11: GLYCOSMIS FALLS, PANGALI COVE, KOOLAMA BAY

Early morning cruise around Cape Londonderry, the most northerly point of Western Australia. We then visit Glycosmis Falls to view a unbelievable Kimberley waterfall before witnessing the survivors camp at Pangali Cove where you can enjoy a freshwater dip beneath a waterfall. In the afternoon we visit Koolama Bay, where the vessel 'Koolama' was beached in February 1942, following the attack by the Japanese in World

War II. The passengers were taken ashore on orders, by the ship's master and many had to walk overland on an epic cross-country trek.

#### DAY 12: KING GEORGE RIVER

At high tide, we cross the sandbars of the King George River, for a breathtaking cruise along this majestic cathedral-like gorge. This incredible scenery unfolds as we approach the King George Falls, a dual waterfall that has an uninterrupted vertical drop of over 80m, making it one of the tallest waterfalls in Western Australia. The Kimberley Quest II is able to cruise to the base of the twin falls for a refreshing 'shower', Kimberley style! For those intrepid adventurers, you may climb to the top for a breathtaking vista of the river below, a truly humbling experience as you appreciate the immensity of this untamed landscape, followed by a refreshing dip. Overnight we anchor just metres away from the falls, with tranquil sounds and an extraordinary view from the bow.

#### DAY 13: BERKELEY RIVER, CAMBRIDGE GULF

Early morning we cruise up the Berkeley River, taking in the numerous waterfalls and ancient sandstone escarpments. Take an excursion with our guides to go crocodile-spotting and bird watching or try your luck at fishing. Marvel at the amphitheatre waterfalls and then cool off in beautiful freshwater pools. Late afternoon we take a tender excursion up to the back of the Berkeley River, where the saltwater meets the freshwater. Fish off the flat rocks for barramundi which are lurking in the rapids, alternatively walk to a fresh water pool to enjoy a relaxing dip. Savour your last evening under the Kimberley skies as we cruise down Cambridge Gulf, journey through the night towards the township of Wyndham.

The Small Cruise Ship Collection

[www.small-cruise-ships.com](http://www.small-cruise-ships.com)

01432 507 280 (within UK)

[info@small-cruise-ships.com](mailto:info@small-cruise-ships.com) | [small-cruise-ships.com](http://small-cruise-ships.com)



The Small Cruise  
Ship Collection

[www.small-cruise-ships.com](http://www.small-cruise-ships.com)

[small-cruise-ships.com](http://small-cruise-ships.com)

[info@small-cruise-ships.com](mailto:info@small-cruise-ships.com)

**DAY 14: WYNDHAM PORT - KUNUNURRA**

Arrive into Wyndham Port early morning. Enjoy your last breakfast onboard before saying goodbye to the crew of the Kimberley Quest II. Board a courtesy coach at 7.30am for transfer to Kununurra (100kms), arriving at approximately 9.00am.

**Please Note:**

Whilst the published itinerary can be used as a guide, due to weather, tidal movements and the nature of cruising in the Kimberley itineraries may be subject to change. Each evening on-board your cruise the Captain will discuss the coming days planned activities and experiences and you will have the opportunity to discuss the activities and ask questions.

# The Small Cruise Ship Collection

[www.small-cruise-ships.com](http://www.small-cruise-ships.com)

[small-cruise-ships.com](http://small-cruise-ships.com)

[info@small-cruise-ships.com](mailto:info@small-cruise-ships.com)

## YOUR SHIP: KIMBERLEY QUEST II

|                            |                           |
|----------------------------|---------------------------|
| <b>YOUR SHIP:</b>          | <b>Kimberley Quest II</b> |
| <b>VESSEL TYPE:</b>        | <b>Luxury Expedition</b>  |
| <b>LENGTH:</b>             | <b>24 metres</b>          |
| <b>PASSENGER CAPACITY:</b> | <b>18</b>                 |
| <b>BUILT/REFURBISHED:</b>  | <b>2005</b>               |

The Kimberley Quest II has been designed for relaxing and exploring the Kimberley coastline in complete comfort and style. This custom-built vessel is fully air-conditioned, equipped with a helipad, spa, large en-suited cabins and offers indoor and outdoor alfresco areas so there will always be plenty of room to take in the panoramic scenery and breathtaking sunsets. Whilst on board take advantage of the extensive library, including a fantastic array of Kimberley reference books and general interest novels, otherwise sit with the Captain in the wheelhouse and learn more about the Kimberley outback. Accommodating just 18 passengers and 6 crew, your holiday of a lifetime can be enjoyed with fellow travelers in luxurious and intimate surrounds. You have the choice of 9 cabins from deluxe twin, double, superior and the exclusive flybridge. All cabins feature private ensuites, individual air-conditioning, viewing windows, mini-refrigerators and are serviced daily by your hostess. Carrying three excursion tenders, days are filled with a myriad of activities both on and off land, exploring the spectacular region with your very own local guide who has extensive knowledge of the Kimberley coastline. During your cruise you are free to do as much or as little as you wish and can be sure that your

Kimberley Cruise with us will exceed your



expectations!

The Small Cruise Ship Collection  
[www.small-cruise-ships.com](http://www.small-cruise-ships.com)

**01432 507 280** (within UK)

[info@small-cruise-ships.com](mailto:info@small-cruise-ships.com) | [small-cruise-ships.com](http://small-cruise-ships.com)

# The Small Cruise Ship Collection

[www.small-cruise-ships.com](http://www.small-cruise-ships.com)

[small-cruise-ships.com](http://small-cruise-ships.com)

[info@small-cruise-ships.com](mailto:info@small-cruise-ships.com)

## INSIDE YOUR SHIP

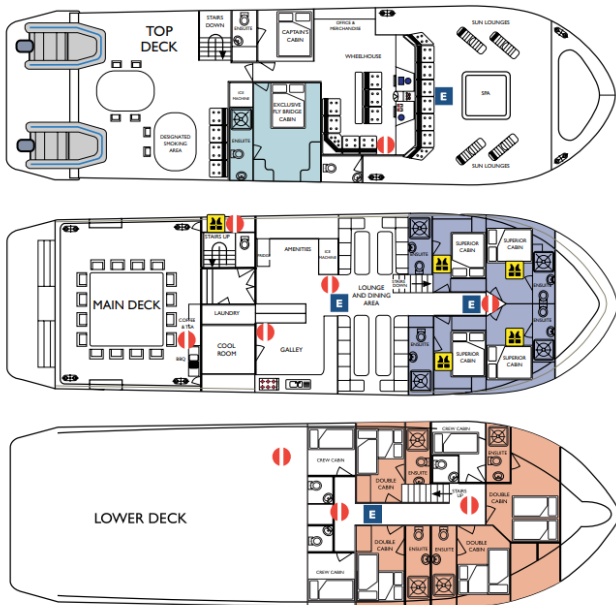

Double Cabin



Flybridge Cabin



Superior Cabin





# The Small Cruise Ship Collection

[www.small-cruise-ships.com](http://www.small-cruise-ships.com)

[small-cruise-ships.com](http://small-cruise-ships.com)

[info@small-cruise-ships.com](mailto:info@small-cruise-ships.com)

## PRICING

### 01-Mar-2025 to 14-Mar-2025

|                 |               |
|-----------------|---------------|
| Double Cabin    | £11622 GBP pp |
| Flybridge Cabin | £14019 GBP pp |
| Superior Cabin  | £13254 GBP pp |

### 25-Mar-2025 to 07-Apr-2025

|                 |               |
|-----------------|---------------|
| Superior Cabin  | £13254 GBP pp |
| Double Cabin    | £11622 GBP pp |
| Flybridge Cabin | £14019 GBP pp |

### 08-Apr-2025 to 21-Apr-2025

|                 |               |
|-----------------|---------------|
| Double Cabin    | £11622 GBP pp |
| Superior Cabin  | £13254 GBP pp |
| Flybridge Cabin | £14019 GBP pp |

### 22-Apr-2025 to 05-May-2025

|                 |               |
|-----------------|---------------|
| Flybridge Cabin | £14019 GBP pp |
| Double Cabin    | £11622 GBP pp |
| Superior Cabin  | £13254 GBP pp |

### 10-Mar-2026 to 23-Mar-2026

|                 |               |
|-----------------|---------------|
| Double Cabin    | £11625 GBP pp |
| Superior Cabin  | £13255 GBP pp |
| Flybridge Cabin | £14025 GBP pp |

### 24-Mar-2026 to 06-Apr-2026

|                 |               |
|-----------------|---------------|
| Flybridge Cabin | £14025 GBP pp |
| Superior Cabin  | £13255 GBP pp |
| Double Cabin    | £11625 GBP pp |

### 07-Apr-2026 to 20-Apr-2026

|                 |               |
|-----------------|---------------|
| Double Cabin    | £11625 GBP pp |
| Flybridge Cabin | £14025 GBP pp |
| Superior Cabin  | £13255 GBP pp |

### 21-Apr-2026 to 04-May-2026

|                 |               |
|-----------------|---------------|
| Double Cabin    | £11625 GBP pp |
| Flybridge Cabin | £14025 GBP pp |
| Superior Cabin  | £13255 GBP pp |