



The Small Cruise  
Ship Collection

[www.small-cruise-ships.com](http://www.small-cruise-ships.com)

[small-cruise-ships.com](http://small-cruise-ships.com)

[info@small-cruise-ships.com](mailto:info@small-cruise-ships.com)

## GREAT BEAR RAINFOREST AUTUMN - CANADA CATAMARAN CRUISE

Journey into one of Earth's greatest wild places. Robert Kennedy Jr. calls it "the last stand of the great North American rainforest". It is a land of fjords, mountains, rainforests, and great river estuaries. It is home to grizzlies, wolves and the mysterious white Spirit Bear. Maple Leaf's trips are timed for peak experiences of natural beauty and wildlife.

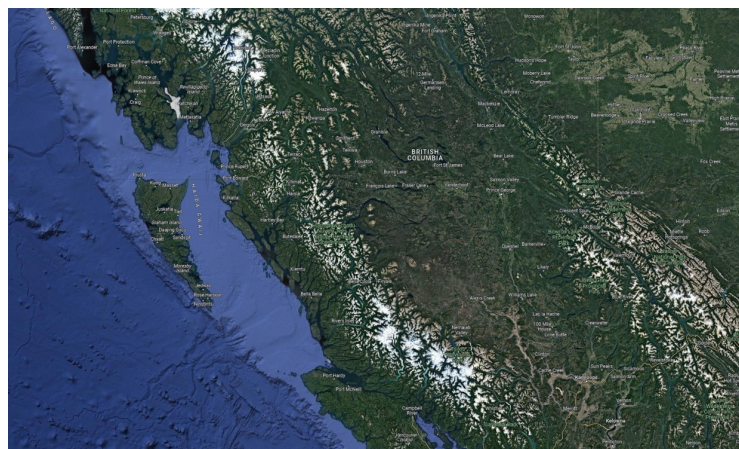

### ITINERARY

#### Day 1 Haisla territory

Welcome aboard in Haisla territory, cruising to evening anchorage, watching for whales. Evening rainforest walk before dinner.

#### Day 2 Cruising

Cruising down a spectacular, long fjord, where granite mountains rise from thousands of feet below in the sea. Viewing waterfalls and possible mountain goats. Exploring ashore in estuary meadows, where some bears spend their days in the autumn. Learning about the daily life of bears, and the salmon cycle. Optional evening kayaking.

#### Day 3 Great Bear's island channels

Bear viewing among the fjords. Learning the indigenous history and stories of special sites in the region. Cruising the Great Bear's island channels. Visit to village of Hartley Bay for a big

The Small Cruise  
Ship Collection

[www.small-cruise-ships.com](http://www.small-cruise-ships.com)

01432 507 280 (within UK)

[info@small-cruise-ships.com](mailto:info@small-cruise-ships.com) | [small-cruise-ships.com](http://small-cruise-ships.com)



## The Small Cruise Ship Collection

[www.small-cruise-ships.com](http://www.small-cruise-ships.com)

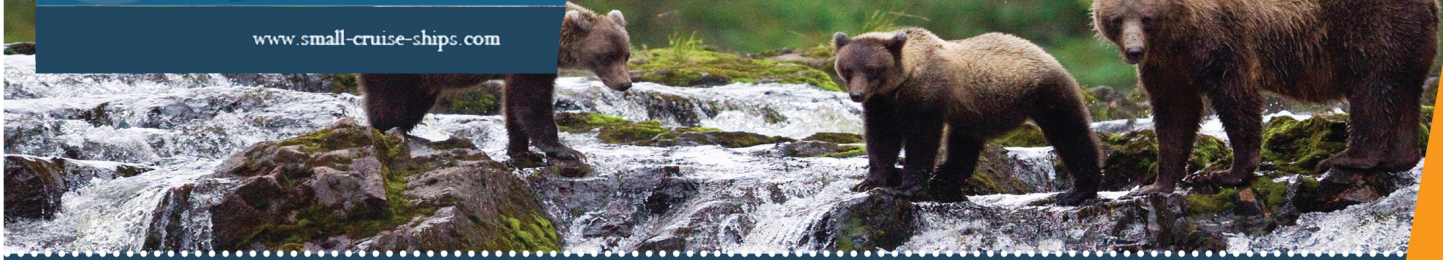

[small-cruise-ships.com](http://small-cruise-ships.com)

[info@small-cruise-ships.com](mailto:info@small-cruise-ships.com)

house tour and cultural introduction by local guide.

#### Day 4 Whale Channel region

Cruising Whale Channel region, a critical habitat for several species of whales. Whale viewing. Visit whale researchers at remote station. Sea lion viewing. Island anchorage.

#### Day 5 Great Bear Rainforest's wild outer islands and beaches

Visit the Great Bear Rainforest's wild outer islands and beaches. Beach visit and hike to views over the Pacific ocean. Kayaking or optional fishing. Cruising to and exploring archipelago of tiny islands, some areas so wild they're not yet fully charted. Seabird viewing.

#### Day 6 Rainforest walk and salmon spawning stream

Rainforest walk and salmon spawning stream. Cruising to historic cannery site of Butedale on Princess Royal Island. Optional hike to lake.

#### Day 7 Full day at viewing site

Visit island known as the epicentre of spirit bears with local guides as well as Cascadia's bear guides. Full day at viewing site for the best opportunity to view a spirit bear. Last night celebration dinner and events.

#### Day 8 Kitimat

Cruising to Kitimat, watching for wildlife.

#### Please Note:

Note that as with all expedition cruises, the itinerary may change based on weather, wildlife activity, and interests of the guests. This itinerary is to give you a general idea of the trip.



The Small Cruise  
Ship Collection

[www.small-cruise-ships.com](http://www.small-cruise-ships.com)

**01432 507 280** (within UK)

[info@small-cruise-ships.com](mailto:info@small-cruise-ships.com) | [small-cruise-ships.com](http://small-cruise-ships.com)



## The Small Cruise Ship Collection

[www.small-cruise-ships.com](http://www.small-cruise-ships.com)

[small-cruise-ships.com](http://small-cruise-ships.com)

[info@small-cruise-ships.com](mailto:info@small-cruise-ships.com)

## YOUR SHIP: CASCADIA

**YOUR SHIP:** **Cascadia**

**VESSEL TYPE:**

**LENGTH:**

**PASSENGER CAPACITY:**

**BUILT/REFURBISHED:**

Cascadia is a go-anywhere, expedition style catamaran. She accommodates up to 24 guests in 12 luxurious cabins, with a crew of 10. She is unlike any other vessel offering expeditions on the British Columbia coast, having been built specifically for high-quality, boutique cruises. Light, spacious and comfortable, she is also capable of reaching the wildest, most naturally rich places on the coast. Her small size and guest numbers provide an authentic, human-scale experience that respects the carrying capacity of coastal inlets and communities. Ship And Accommodations Find comfort and solitude in your private cabin or enjoy time in any of the interior or outdoor lounges, or the "open" bridge. Cascadia's large windows bring the outside in, and her separate dining area becomes a sophisticated "long table" event for meals. Her decks are wide and welcoming, with seating areas on different levels. Salon Large windows surround the salon making it a perfect place to look for whales while staying protected, chat with other guests while lounging on our comfortable sofas, or enjoy a beverage from the nearby bar. Dining Area Enjoy our chefs' fine west-coast influenced creations while watching the sun go down. Sit and discuss your day's adventure with your captain, afloat in a remote natural

anchorage. Terrace Lounge And Dining Area Dine alfresco on temperate evenings, lounge with your morning coffee, or watch the world go by during the day. This area is the perfect mix of outside and inside. Bridge of Cascadia Cascadia's bridge is open to you. You'll have 180-degree views from here, along with being able to learn about navigation and the vessel systems from our crew. On the port side, you may also enjoy our indoor-outdoor loveseat. You can watch the world go by from behind a protective window, but still have quick access to the fresh air and the deck for whale watching. Top Deck & Hot Tub Lounge on a chaise, soak under the stars, or enjoy the bird's eye view of the ship and the world around her from Cascadia's new top deck. Cabins All cabins have individual climate control, wardrobes and an outside location, with windows for natural light. All have ensuites. All are 'outside' cabins, with windows for natural light. Kayaks, Shore Boats, Naturalist Tools Cascadia has 6 double and 2 single kayaks for paddling in coves and bays, as well as two beautiful landing craft style tenders, custom designed for our program. She carries a suite of tools for exploring the natural world, including a hydrophone for listening to whales. Her library contains books on the cultural history and nature of the BC and

The Small Cruise Ship Collection  
[www.small-cruise-ships.com](http://www.small-cruise-ships.com)

**01432 507 280** (within UK)

[info@small-cruise-ships.com](mailto:info@small-cruise-ships.com) | [small-cruise-ships.com](http://small-cruise-ships.com)



# The Small Cruise Ship Collection

[www.small-cruise-ships.com](http://www.small-cruise-ships.com)



[small-cruise-ships.com](http://small-cruise-ships.com)

[info@small-cruise-ships.com](mailto:info@small-cruise-ships.com)



Alaska coast.



The Small Cruise Ship Collection

[www.small-cruise-ships.com](http://www.small-cruise-ships.com)

**01432 507 280** (within UK)

[info@small-cruise-ships.com](mailto:info@small-cruise-ships.com) | [small-cruise-ships.com](http://small-cruise-ships.com)

# The Small Cruise Ship Collection

[www.small-cruise-ships.com](http://www.small-cruise-ships.com)

[small-cruise-ships.com](http://small-cruise-ships.com)

[info@small-cruise-ships.com](mailto:info@small-cruise-ships.com)

## INSIDE YOUR SHIP

TOP DECK

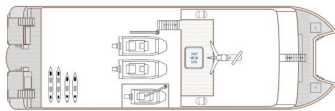

BRIDGE DECK

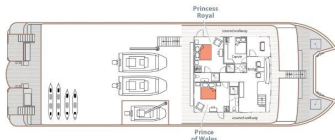

MAIN DECK



LOWER DECK



Category 1



Category 2



Category 3





# The Small Cruise Ship Collection

[www.small-cruise-ships.com](http://www.small-cruise-ships.com)



[small-cruise-ships.com](http://small-cruise-ships.com)

[info@small-cruise-ships.com](mailto:info@small-cruise-ships.com)

## PRICING

### 23-Sep-2024 to 30-Sep-2024

Category 3	£9879 GBP pp
Category 2	£8675 GBP pp
Category 1	£7469 GBP pp

### 01-Oct-2024 to 08-Oct-2024

Category 1	£7469 GBP pp
Category 3	£9879 GBP pp
Category 2	£8675 GBP pp

### 09-Oct-2024 to 16-Oct-2024

Category 3	£9879 GBP pp
Category 2	£8675 GBP pp
Category 1	£7469 GBP pp



The Small Cruise Ship Collection

[www.small-cruise-ships.com](http://www.small-cruise-ships.com)

01432 507 280 (within UK)

[info@small-cruise-ships.com](mailto:info@small-cruise-ships.com) | [small-cruise-ships.com](http://small-cruise-ships.com)